



# Study Guide

Calgary Campus

## About

This guide identifies study areas on the Calgary Campus and identifies study areas off the campus. This guide will also help you find resources on how to improve and who to contact for your studying and learning needs.

## Study Areas on Campus – North Building

### Legend

	Official Study Areas
	Quiet Study Areas
	Unofficial Study Areas
	Off-Campus Study Areas

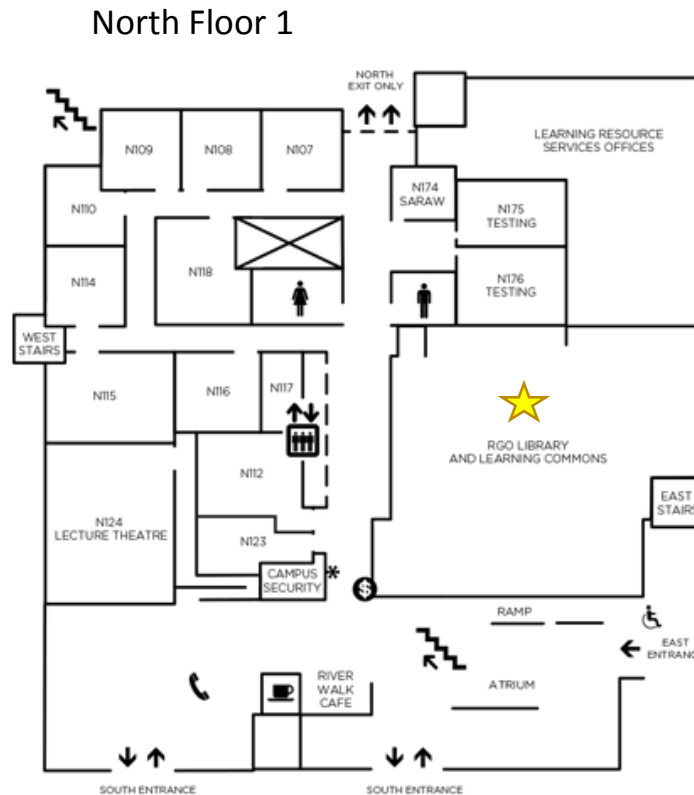

Bow Valley College Library

Hours:





Monday – Thursday: 8:00am – 7:00pm

Friday: 8:00am – 5:00pm

Saturday: 9:00am – 5:00pm

Sunday: CLOSED

Legend

	Official Study Areas
	Quiet Study Areas
	Unofficial Study Areas
	Off-Campus Study Areas



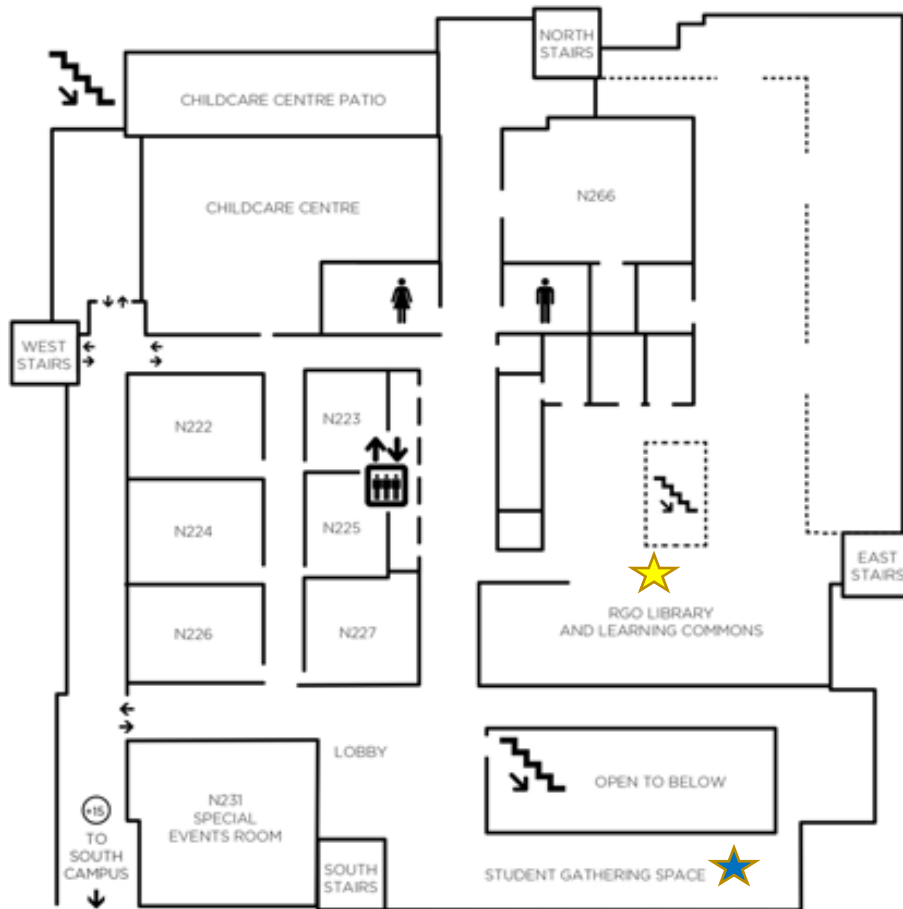

North Floor 2

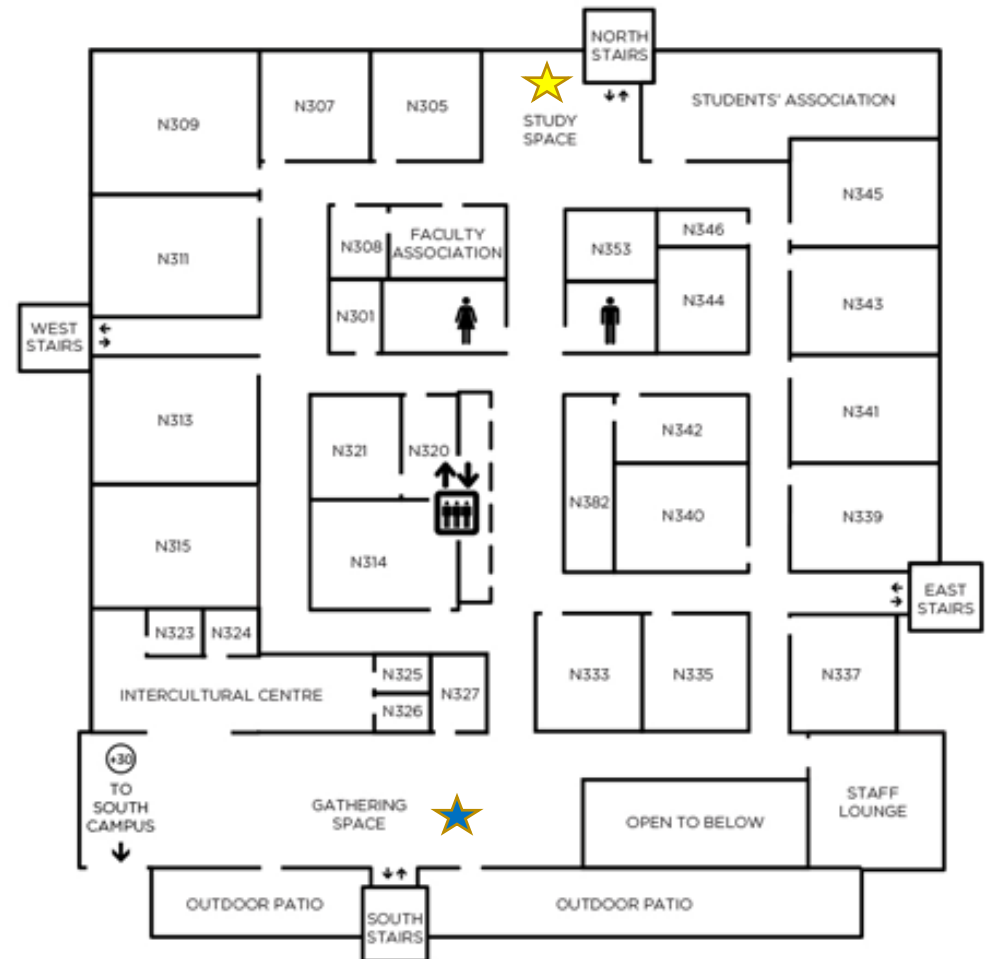

North Floor 3



Legend

	Official Study Areas
	Quiet Study Areas
	Unofficial Study Areas
	Off-Campus Study Areas

North Floor 4

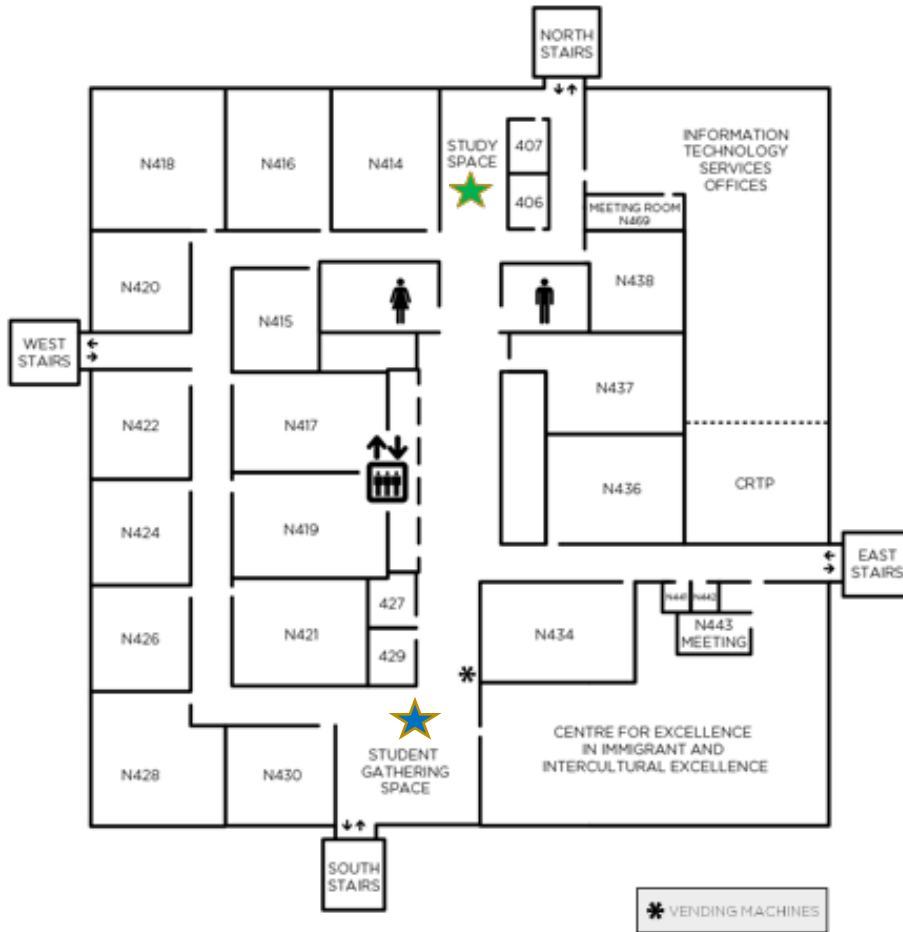

North Floor 5

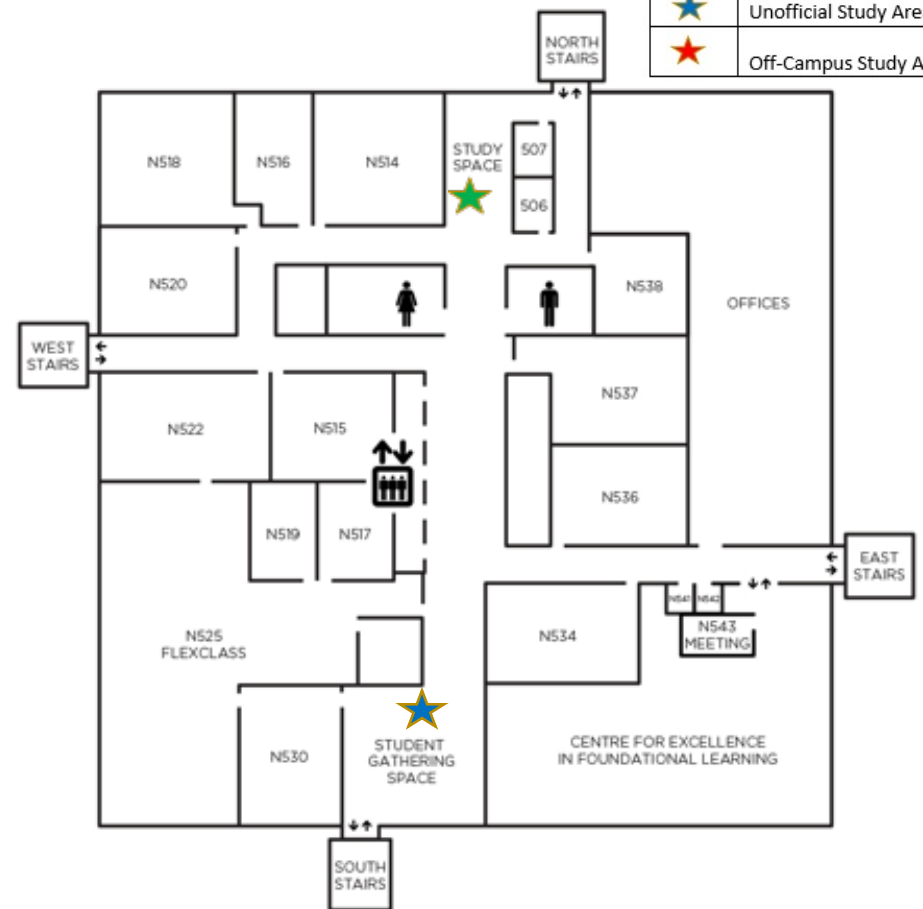

Work Rooms (N407, N406, N506, N507):

Work room availability is based on a first come, first serve basis

Legend

	Official Study Areas
	Quiet Study Areas
	Unofficial Study Areas
	Off-Campus Study Areas

North Floor 6

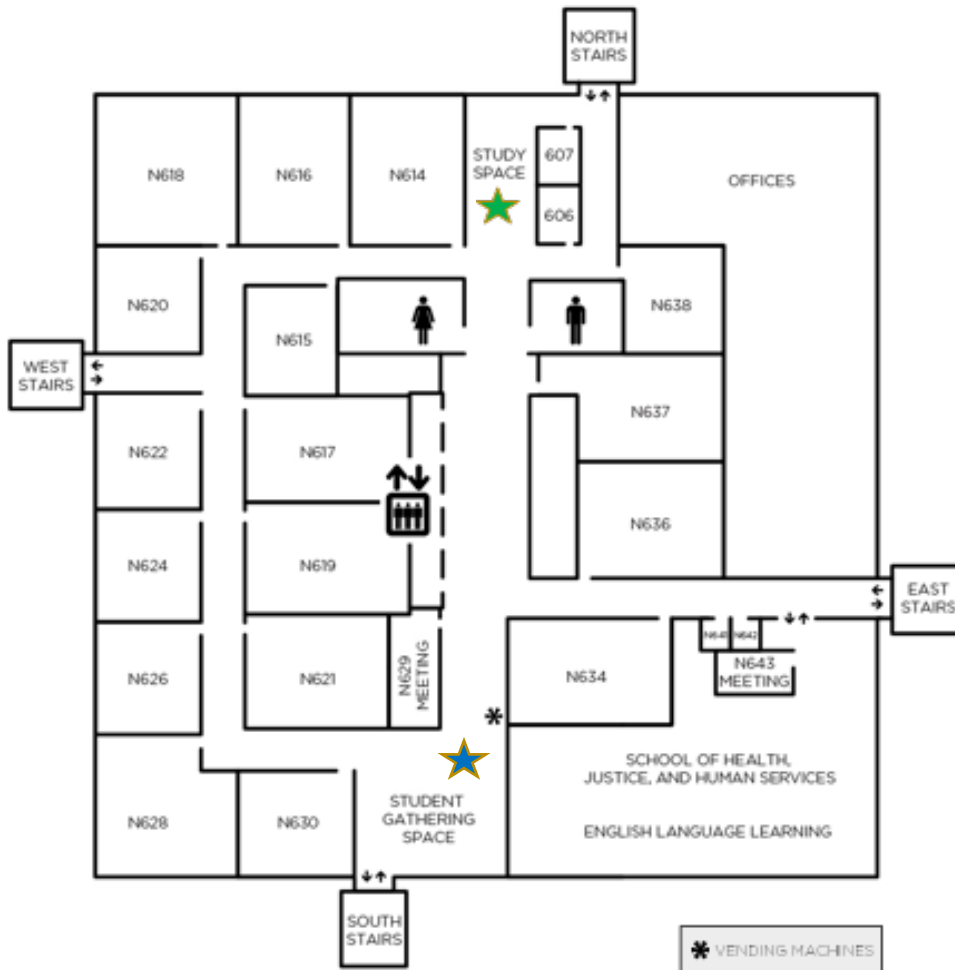

North Floor 7

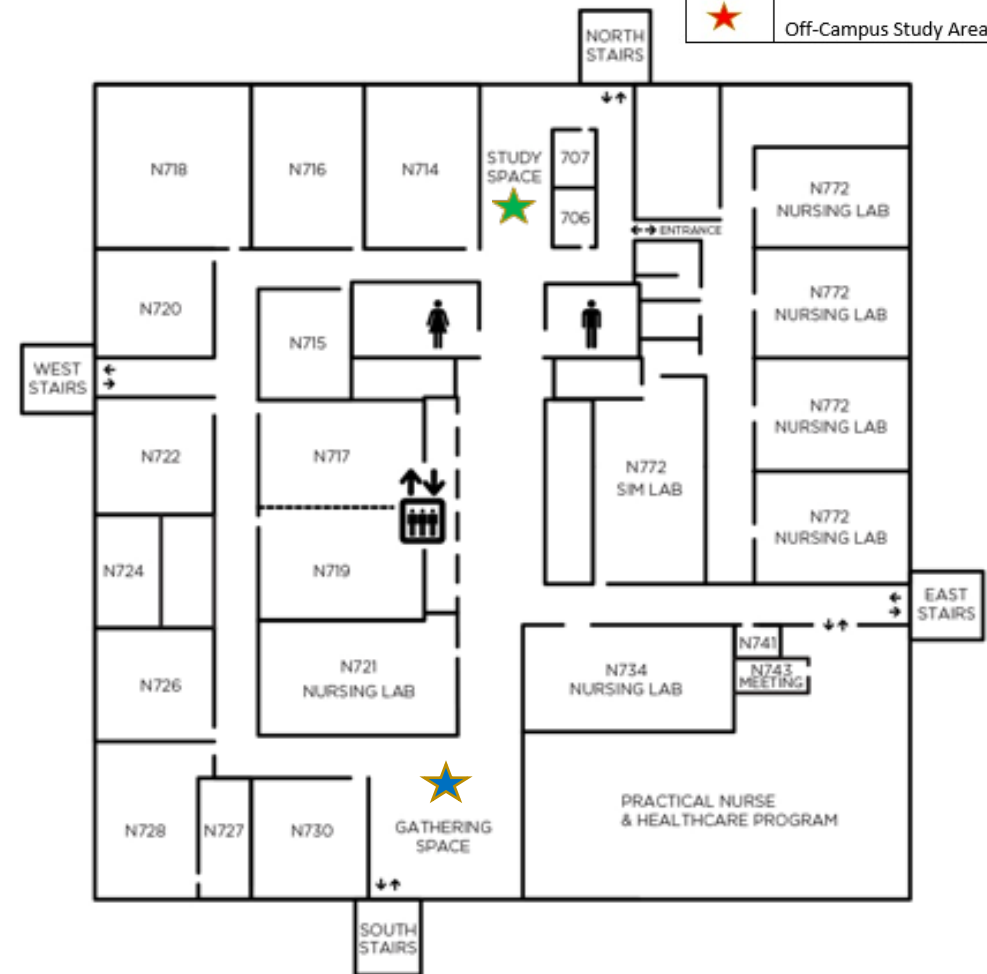

Work Rooms (N606, N607, N706, N707)

Work room availability is based on a first come, first serve basis

Legend

	Official Study Areas
	Quiet Study Areas
	Unofficial Study Areas
	Off-Campus Study Areas

# Study Areas on Campus – South Building

TO NORTH CAMPUS





South Floor 2

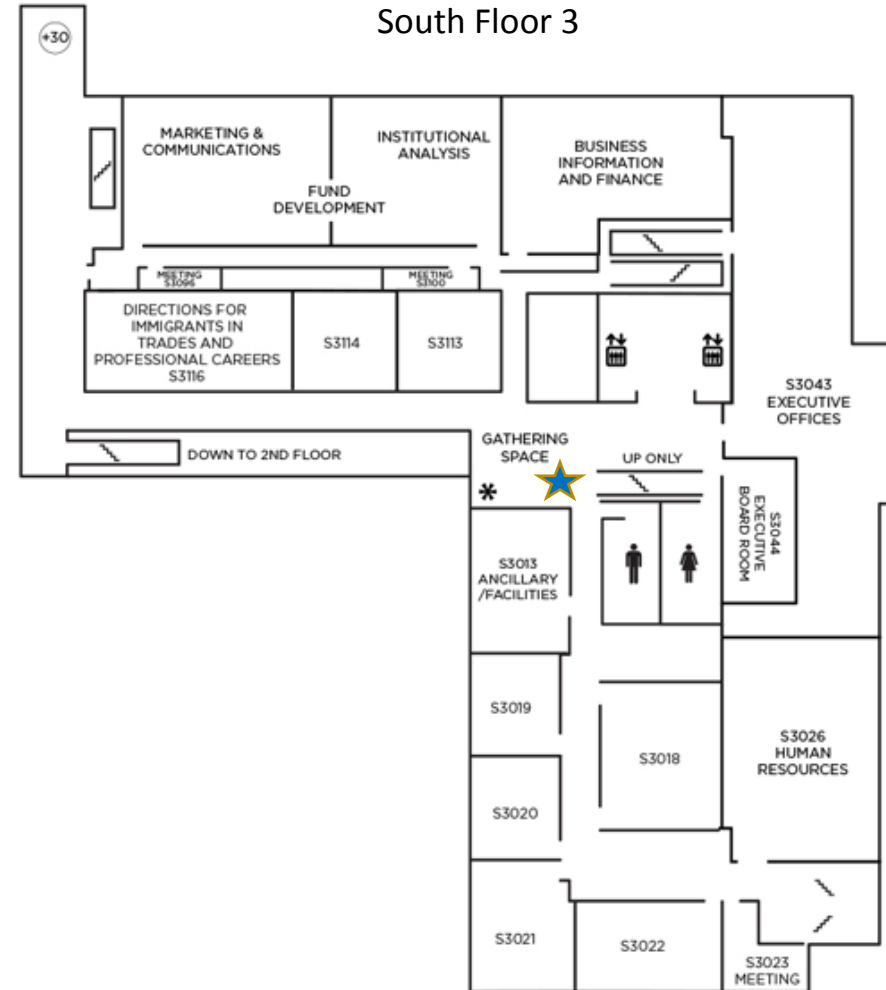

South Floor 3



Legend

	Official Study Areas
	Quiet Study Areas
	Unofficial Study Areas
	Off-Campus Study Areas

South Floor 4



South Floor 5

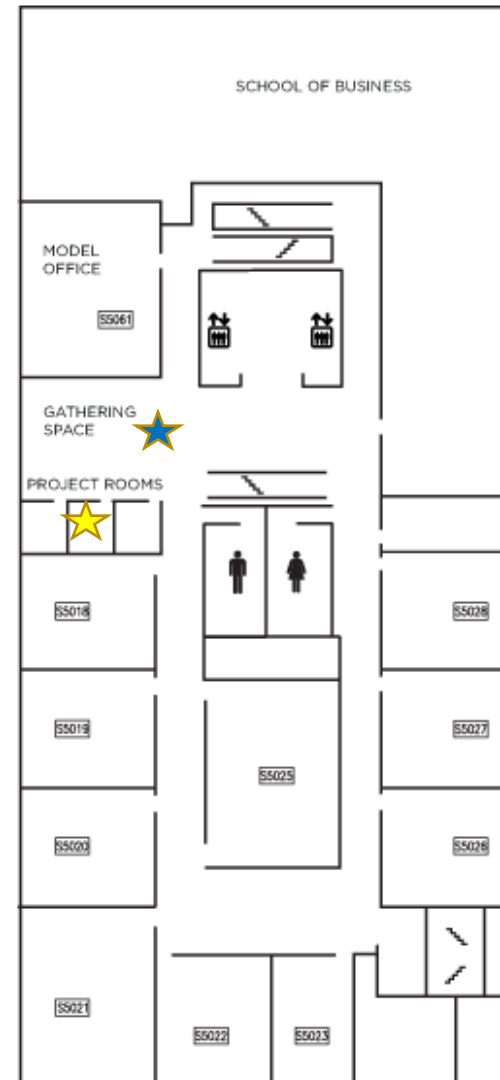

Work Rooms:

Work room availability is based on a first come, first serve basis





South Floor 6



South Floor 7



Legend

	Official Study Areas
	Quiet Study Areas
	Unofficial Study Areas
	Off-Campus Study Areas

Work Rooms on the 7<sup>th</sup> Floor:

Work rooms become available to all students after 4:30pm.

Work room availability is based on a first come, first serve basis



## Study Areas Off Campus

### The Alberta Library (TAL) Card:

The TAL card enables students to borrow materials, study and work on projects from the over 300 participating libraries in Alberta, including public, government, and post-secondary libraries. List of participants: <http://www.thealbertalibrary.ab.ca/members>

Possible libraries to use:

- SAIT Library
- University of Calgary Library
- Mount Royal University Library
- Calgary Public Libraries
  - Nearest Calgary Public Library to Calgary Campus is the Central Library



### Calgary Public Library – Central Library

616 Macleod Trail SE, Calgary AB T2G 2M2

#### Hours:

Monday to Thursday: 9:00am – 8:00pm

Friday: 9:00am – 5:00pm

Saturday: 10:00am – 5:00pm

Sunday: 12:00pm – 5:00pm

Closed Sundays: mid-May to mid-September

#### Quiet Study Floors:

4<sup>th</sup> and 5<sup>th</sup> floors



**Council of Prairie and Pacific University Libraries (COPPUL) Card:**

The COPPUL card enables students to borrow materials, study and work on projects from the 39 COPPUL university libraries located across Canada. List of participants: <http://www.coppul.ca/organizations>

**How to Get a TAL Card or COPPUL Card:**

Come see us at the University of Lethbridge Calgary Campus office!

We are located on the 6<sup>th</sup> floor of the South Building:

Suite S6032, 345 - 6th Avenue SE

Calgary, Alberta, T2G 4V1



## Study Resources

Studying is something that all students are expected to do, yet very few are ever shown how to do it effectively. Many students think studying involves simply reviewing their notes again and again. In fact, reading and rereading your notes leads to recognition, not understanding or knowing. You need to get actively involved with the information that you are studying. Manipulating the information that you are trying to study by doing things like review questions, making diagrams, or concept mapping will not only help you to learn the information much better, it'll be a whole lot more interesting as well.

### Learning Strategist / Study Skills Services

The Learning Strategist office at the U of L can provide you with suggestions and best practices for improving your grades through better note taking, exam taking and preparation, time management and other academic strategies and assistance that can be applied to all courses in all disciplines.

You can access learning strategies and study skills support by scheduling a free, confidential, one-on-one appointment with a learning strategist at the Student Success Centre. Calgary Campus students can access these services via meetings online or by phone. To book an appointment, go to <http://www.uleth.ca/study-skills-services/appointments>.

Phone: (403) 332-4667

Email: [learning.strategist@uleth.ca](mailto:learning.strategist@uleth.ca)



# Tutoring Resources

## Tutoring Services

You can request tutoring through the Lethbridge campus and will be matched with a tutor who is also based in Calgary. You are encouraged to contact Tutoring Services to request assistance with a specific course either prior to the start of the semester or during the first few weeks of the term.

Free tutoring is also available for 1st and 2nd year courses and can be arranged through the Student Success Centre. Check out <http://www.uleth.ca/tutoring-services/>.

Phone: (403) 332-4668

Email: [tutoring.services@uleth.ca](mailto:tutoring.services@uleth.ca)

## eTutor Alberta

eTutor Alberta is an online tutoring service available to students from many universities and colleges in Alberta, including the U of L. U of L Calgary Campus students who wish to use these services need to visit the eTutor website and follow the steps to create an account. Check out <http://www.etutoralberta.ca/>.

Turnaround time is 24 – 48 hours for both writing critique and mathematics assistance. (Note: The turnaround time might take longer during the peak periods of the semester).

eTutor Alberta can help with:

### Writing:

During the school year a student can submit term papers and other written reports for critiquing. Students can submit the same paper / report to eTutor up to three times.

### Mathematics:

eTutors can help with your math problems. Submit a question for feedback or drop into an online classroom to meet with a tutor in real time.